

Proposed Roof Plan

1:100@A2

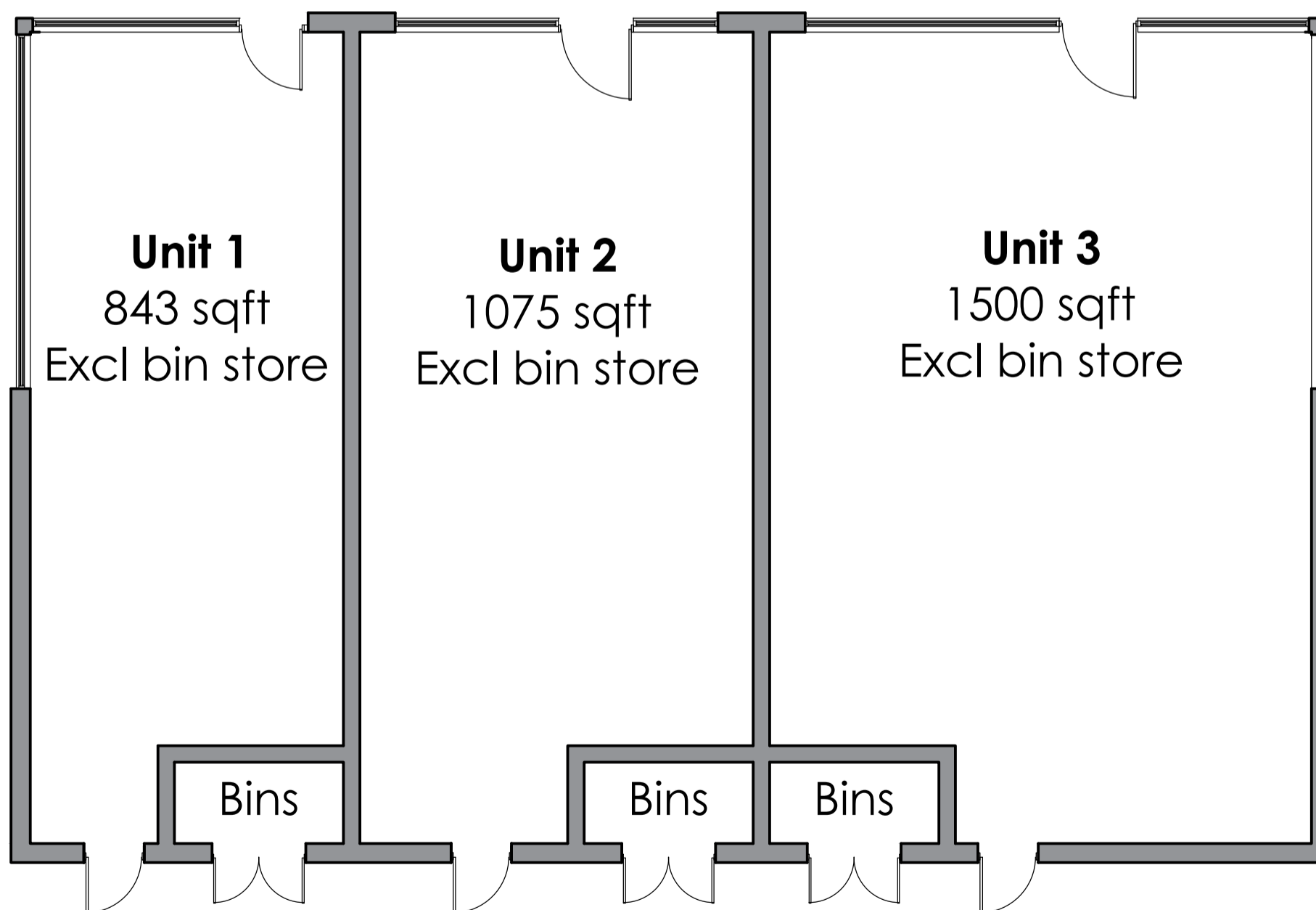

Rev Date Note

Status:
PLANNING



West Hart Partnership Ltd.
Chartered Architects
5 Aldergate,
Tamworth,
Staffs.
B79 7DJ
01827 67123
post@westhart.com
www.westhart.com

Client:

HDD

Project:
Plot 4 Perry Court
Faversham

Drawing title:
Proposed Floor &
Roof Plans

Drawing number:
1416-134

Date of first issue:
17/07/2020

Revision:
B

Scale / Paper size:
1:100 / A2

Drawn by / checked by:
JH / SW

This drawing and the building works depicted are the copyright of West Hart Partnership Ltd and may not be reproduced except by written permission. This drawing must be read and checked against any specialist drawings and information provided. Do not scale from this drawing when using this for construction purposes. use figured dimensions only.
© West Hart Partnership Ltd 2014

Proposed Floor Plan

1:100@A2

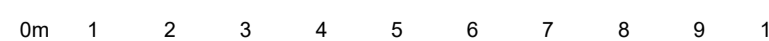

1:100 Scale Bar